



HD-PE

PIPE FITTING VALVE

HD-PE STUB FLANGE

acc. DIN 16962/16963
for butt welding
molded from PE100

對接中間法蘭
DFP FT1

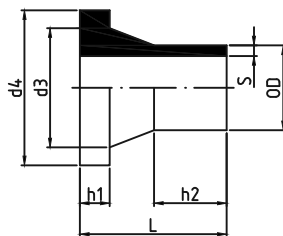

OD20 ~ OD50

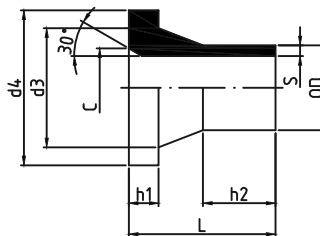

OD63 ~ OD1200

OD (mm)	L (mm)	d ₃ (mm)	d ₄ (mm)	h ₂ (mm)	SDR17 ISO S8 PN10			SDR11 ISO S5 PN16		
					Code	S (mm)	h ₁ (mm)	Code	S (mm)	h ₁ (mm)
20	50.8	27.7	44.8	28.0	-	-	-	31-FT1-11-0020	2.0	7.2
25	51.0	32.5	57.9	30.0	-	-	-	31-FT1-11-0025	2.3	9.2
32	50.9	40.1	68.0	26.0	31-FT1-17-0032	2.0	10.0	31-FT1-11-0032	2.9	10.0
40	50.2	50.0	77.9	22.5	31-FT1-17-0040	2.4	11.0	31-FT1-11-0040	3.7	11.0
50	50.8	60.6	87.9	22.5	31-FT1-17-0050	3.0	12.2	31-FT1-11-0050	4.6	12.2
63	50.1	73.8	102.1	19.0	31-FT1-17-0063	3.8	14.0	31-FT1-11-0063	5.8	14.0
75	49.8	85.0	121.9	19.0	31-FT1-17-0075	4.5	16.1	31-FT1-11-0075	6.8	16.1
90	80.0	104.0	137.7	41.0	31-FT1-17-0090	5.4	17.0	31-FT1-11-0090	8.2	17.0
110	80.0	125.0	158.0	39.0	31-FT1-17-0110	6.6	18.2	31-FT1-11-0110	10.0	18.2
125	175.0	135.0	157.9	100.0	31-FT1-17-0125	7.4	25.5	31-FT1-11-0125	11.4	25.5
140	197.1	155.0	191.0	129.7	31-FT1-17-0140	8.3	27.4	31-FT1-11-0140	12.7	27.4
160	160.5	175.0	212.1	110.0	31-FT1-17-0160	9.5	26.2	31-FT1-11-0160	14.6	26.2
180	180.0	186.0	212.0	127.0	31-FT1-17-0180	10.7	26.5	31-FT1-11-0180	16.4	26.5
200	213.0	229.0	217.0	141.5	31-FT1-17-0200	11.9	31.5	31-FT1-11-0200	18.2	31.5
225	213.0	237.0	268.0	145.0	31-FT1-17-0225	13.4	33.0	31-FT1-11-0225	20.5	33.0
250	273.0	284.0	320.0	202.0	31-FT1-17-0250	14.8	34.0	31-FT1-11-0250	22.7	34.0
280	375.0	292.0	320.0	302.0	31-FT1-17-0280	16.6	32.0	31-FT1-11-0280	25.4	32.0
315	379.0	334.0	370.0	302.0	31-FT1-17-0315	18.7	35.0	31-FT1-11-0315	28.6	35.0
355	175.0	373.0	430.0	-	31-FT1-17-0355	21.1	40.0	31-FT1-11-0355	32.2	40.0
400	175.0	427.0	482.0	-	31-FT1-17-0400	23.7	40.0	31-FT1-11-0400	36.3	40.0
450	180.0	514.0	585.0	-	31-FT1-17-0450	26.7	50.0	31-FT1-11-0450	40.9	50.0
500	180.0	530.0	585.0	-	31-FT1-17-0500	29.7	50.0	31-FT1-11-0500	45.4	50.0
560	180.0	615.0	685.0	-	31-FT1-17-0560	33.2	55.0	31-FT1-11-0560	50.8	55.0
630	200.0	642.0	685.0	-	31-FT1-17-0630	37.4	55.0	31-FT1-11-0630	57.2	55.0
710	200.0	737.0	800.0	-	31-FT1-17-0710	42.1	55.0	31-FT1-11-0710	64.5	55.0
800	200.0	-	905.0	-	31-FT1-17-0800	47.4	60.0	31-FT1-11-0800	72.8	60.0
900	230.0	-	1005	-	31-FT1-17-0900	53.3	60.0	31-FT1-11-0900	81.8	60.0
1000	240.0	-	1110	-	31-FT1-17-1000	59.3	70.0	31-FT1-11-1000	90.9	70.0
1200	240.0	-	1330	-	31-FT1-17-1200	67.9	70.0	31-FT1-11-1200	109.1	70.0