



INSPECTION GLASS



EI Series

液面計

EI300
Size: 1/2" - 10"

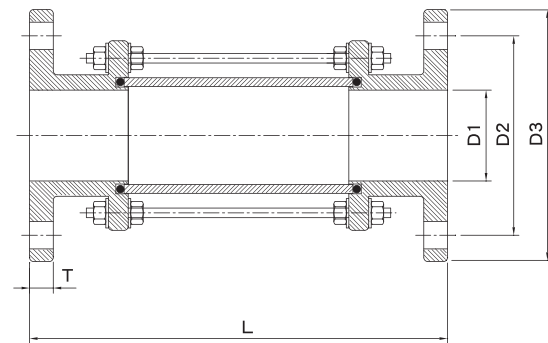

DN15~DN250

Materials	UPVC , PP , CPVC , PPG , PVDF
SIZE	1/2", 3/4", 1", 1-1/4", 1-1/2", 2", 2-1/2", 3", 4", 5", 6", 8", 10"
END CONNECTIONS	Flange ends in JIS 10K DIN ; ANSI;BS STANDARD
WORKING TEMP	UPVC: 0°~60°C , PP:-20°C~90°C , PPG: -20°C~100°C , PVDF:-40°C~120°C
FEATURES	Can be mounted horizontally or vertically internal device induces visible turbulence with minimum flow retraction

● DIMENSIONS TABLE

Nom Size m/m(inch)	D1	D2				D3				L	Test Press		Working Press	
		JIS	DIN	ANSI	BS	JIS	DIN	ANSI	BS		kgf/cm ² (bar)	lb/in ²	kgf/cm ² (bar)	lb/in ²
15(1/2")	16	70	65	2.38	2.62	95	95	3.50	3.75	176	10	150	7	105
20(3/4")	20	75	75	2.76	2.88	100	105	3.86	4.00	174	10	150	7	105
25(1")	25	90	85	3.13	3.25	125	115	4.25	4.50	222	10	150	7	105
32(1-1/4")	30	100	100	3.50	3.43	135	140	4.61	4.75	222	10	150	7	105
40(1-1/2")	40	105	110	3.88	3.88	140	150	5.00	5.25	224	10	150	7	105
50(2")	50	120	125	4.74	4.50	155	165	6.47	6.00	218	10	150	7	105
65(2-1/2")	65	140	145	5.89	5.00	175	185	7.00	6.50	240	10	150	7	105
80(3")	80	150	160	6.00	5.75	185	200	7.52	7.25	238	10	150	7	105
100(4")	100	175	180	7.50	7.00	210	220	9.02	8.50	274	10	150	7	105
125(5")	125	210	210	8.50	8.25	250	250	10.00	10.00	375	5	75	3	45
150(6")	150	240	240	9.51	9.25	280	285	10.98	11.00	386	5	75	3	45
200(8")	200	290	295	11.75	11.50	330	340	13.50	13.25	420	5	75	3	45
250(10")	250	355	350	14.25	14.00	400	395	15.98	16.00	445	5	75	3	45

※ 本尺表以 PVC 材質為準，本表試壓值以 PVC、PVDF 材質為準，PP 材質試壓值為本表試壓值之 70%。

※ 法蘭長度公差依據 EN558-1:1995 標準

The dimension table is calculated based on PVC material.

※ The valve of test pressure is calculated based on PVC PVDF materials.

The valve of test pressure for PP material is 70% based on the table.

The flanged length tolerance is according to EN558-1:1995.