



PVDF/PVDF(FRP COATED)

PIPE FITTING VALVE

PVDF BLIND FLANGE

MACHINED DIN
molded from PVDF

盲法蘭 DIN
DFP FB1

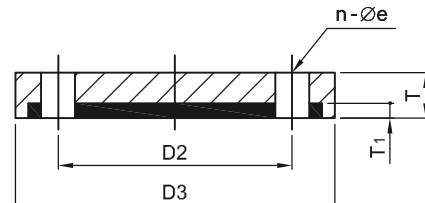
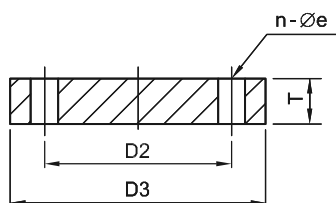

Ø355 ~ Ø630

鋼板加PVDF板(steel w/PVDF sheet)

OD (mm)	D2 (mm)	D3 (mm)	e (mm)	n Number	T (mm)	T ₁ (mm)	Code
20	65	95	14	4	16	-	51-FB1-33-020D
25	75	105	14	4	14	-	51-FB1-33-025D
32	85	115	14	4	18	-	51-FB1-33-032D
40	100	140	18	4	18	-	51-FB1-33-040D
50	110	150	18	4	19	-	51-FB1-33-050D
63	125	165	18	4	19	-	51-FB1-33-063D
75	145	185	18	4	19	-	51-FB1-33-075D
90	160	200	18	8	23	-	51-FB1-33-090D
110	180	220	18	8	23	-	51-FB1-33-110D
125	180	220	18	8	23	-	51-FB1-33-125D
140	210	250	18	8	23	-	51-FB1-33-140D
160	240	285	23	8	23	-	51-FB1-33-160D
180	240	285	23	8	23	-	51-FB1-33-180D
200	295	340	23	8	23	-	51-FB1-33-200D
225	295	340	23	8	23	-	51-FB1-33-225D
250	350	390	23	12	25	-	51-FB1-33-250D
280	350	395	23	12	25	-	51-FB1-33-280D
315	400	445	23	12	25	-	51-FB1-33-315D
355	460	505	30	16	28	8	51-FB1-33-355D
400	515	565	30	16	28	8	51-FB1-33-400D
450	620	670	30	20	30	8	51-FB1-33-450D
500	620	670	30	20	30	8	51-FB1-33-500D
560	725	780	30	20	30	8	51-FB1-33-560D
630	725	780	30	20	30	8	51-FB1-33-630D



PVDF/PVDF(FRP COATED)

PIPE FITTING VALVE

PVDF BLIND FLANGE

MACHINED ANSI
molded from PVDF

盲法蘭 ANSI
DFP FT7

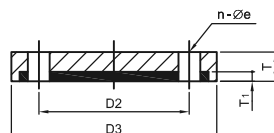
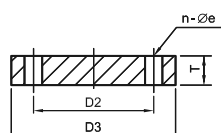

Ø355 ~ Ø630
鋼板加PVDF板(steel w/PVDF sheet)



OD (mm)	DN (inch)	D2 (mm)	D3 (mm)	e (mm)	n Number	T (mm)	T ₁ (mm)	Code
20	1/2"	60	89	16	4	16	-	51-FT7-33-020A
25	3/4"	70	98	16	4	14	-	51-FT7-33-025A
32	1"	79	108	16	4	18	-	51-FT7-33-032A
40	1-1/4"	89	117	16	4	18	-	51-FT7-33-040A
50	1-1/2"	98	127	16	4	19	-	51-FT7-33-050A
63	2"	121	152	19	4	19	-	51-FT7-33-063A
75	2-1/2"	140	178	19	4	19	-	51-FT7-33-075A
90	3"	152	191	19	4	23	-	51-FT7-33-090A
110	4"	191	229	19	8	23	-	51-FT7-33-110A
140	5"	216	254	22	8	23	-	51-FT7-33-140A
160	6"	241	279	22	8	23	-	51-FT7-33-160A
200	8"	298	343	22	8	23	-	51-FT7-33-200A
250	10"	362	406	25	12	25	-	51-FT7-33-250A
315	12"	432	483	25	12	25	-	51-FT7-33-315A
355	14"	476	533	29	12	28	8	51-FT7-33-355A
400	16"	540	597	29	16	28	8	51-FT7-33-400A
450	18"	578	635	32	16	30	8	51-FT7-33-450A
500	20"	635	699	32	20	30	8	51-FT7-33-500A
630	24"	749	813	35	20	30	8	51-FT7-33-630A