



# HD-PE

# PIPE FITTING VALVE

## HD-PE STUB FLANGE

elongated  
for butt welding  
molded from PE100

對接長型中間法蘭  
DFP FT3

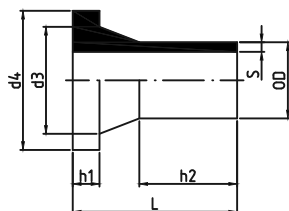

OD20 ~ OD50

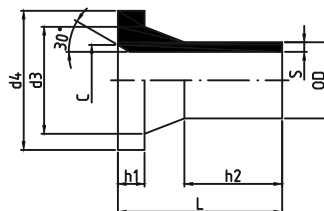

OD63 ~ OD315



OD (mm)	L (mm)	d <sub>3</sub> (mm)	d <sub>4</sub> (mm)	h <sub>2</sub> (mm)	SDR17 ISO S8 PN10			SDR11 ISO S5 PN16		
					Code	S (mm)	h <sub>1</sub> (mm)	Code	S (mm)	h <sub>1</sub> (mm)
20	64.0	27.0	45.0	40.0	-	-	-	31-FT3-11-0032	2.0	7.2
25	64.0	34.0	45.0	39.0	-	-	-	31-FT3-11-0032	2.3	9.2
32	77.0	40.0	68.0	45.0	-	-	-	31-FT3-11-0032	2.9	10.0
40	83.0	50.0	78.0	52.0	-	-	-	31-FT3-11-0040	3.7	11.0
50	92.0	60.0	88.0	56.0	-	-	-	31-FT3-11-0050	4.6	12.2
63	107.0	73.0	102.0	63.0	31-FT3-17-0063	3.8	14.0	31-FT3-11-0063	5.8	14.0
75	108.0	87.0	122.0	70.0	31-FT3-17-0075	4.5	16.0	31-FT3-11-0075	6.8	16.1
90	126.0	104.0	138.0	82.0	31-FT3-17-0090	5.4	17.0	31-FT3-11-0090	8.2	17.0
110	139.0	125.0	158.0	95.0	31-FT3-17-0110	6.6	18.0	31-FT3-11-0110	10.0	18.2
125	175.0	131.5	157.9	100.0	31-FT3-17-0125	7.4	25.0	31-FT3-11-0125	11.4	25.5
140	197.1	155.0	191.0	129.7	31-FT3-17-0140	8.3	27.4	31-FT3-11-0140	12.7	27.4
160	160.0	175.0	211.0	108.0	31-FT3-17-0160	9.5	25.0	31-FT3-11-0160	14.6	26.2
180	180.0	186.0	217.0	125.0	31-FT3-17-0180	10.7	26.5	31-FT3-11-0180	16.4	26.5
200	213.0	229.0	271.0	141.5	31-FT3-17-0200	11.9	31.5	31-FT3-11-0200	18.2	31.5
225	213.0	237.0	268.0	145.0	31-FT3-17-0225	13.4	33.0	31-FT3-11-0225	20.5	33.0
250	273.0	284.0	320.0	202.0	31-FT3-17-0250	14.8	34.0	31-FT3-11-0250	22.7	34.0
280	375.0	292.0	320.0	302.0	31-FT3-17-0280	16.6	32.0	31-FT3-11-0280	25.4	32.0
315	379.0	334.0	370.0	302.0	31-FT3-17-0315	18.7	35.0	31-FT3-11-0315	28.6	35.0