



LABCOCK BALL VALVE



CL Series

實驗式球閥

Size: 1/4"- 3/8", Color: Grey or White

Other Available Combinations Choice:

- 1/4" Female x 1/4" Hose
- 1/4" Female x 3/8" Hose
- 3/8" Female x 1/4" Hose
- 3/8" Female x 3/8" Hose
- 1/4" Male x 1/4" Male
- 1/4" Male x 1/4" Hose
- 1/4" Male x 3/8" Hose
- 3/8" Male x 1/4" Hose
- 3/8" Male x 3/8" Hose
- 1/4" Hose x 1/4" Hose
- 3/8" Hose x 3/8" Hose

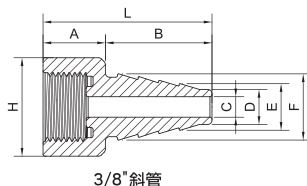
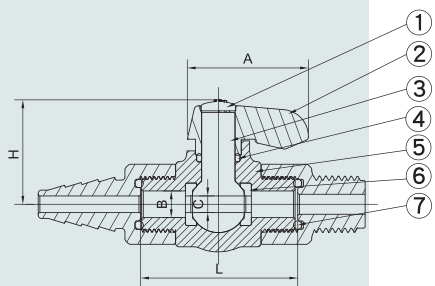

3/8"斜管

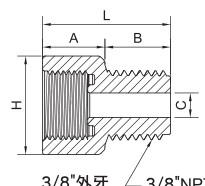

3/8"外牙

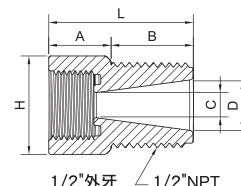

1/2"外牙

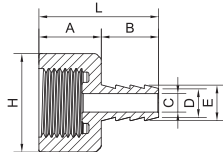

1/4"斜管

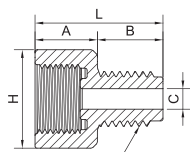

1/4"外牙

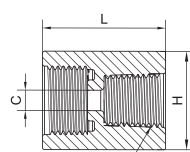

1/4"內牙

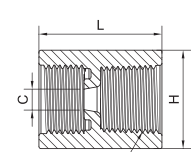

3/8"內牙

MATERIALS OF CONSTRUCTION

Item	Parts	Pcs	Materials
1	Cap	1	UPVC
2	Handle	1	ABS
3	Ball	1	UPVC
4	O'ring	1	EPDM
5	Body	1	UPVC
6	Seat	2	EPDM
7	Seat Carrier O-ring	1	EPDM

DIMENSIONS TABLE

DIMENSIONS									Unit: mm	
Nom. Size. DN-inch	L	H	A	B	C	D	E	F	Testpress (kgf/cm ²)(bar)	Working press (kgf/cm ²)(bar)
1/4" HOSE	37.68	25.04	29.04	6.4	4.0				15	10
3/8" HOSE	41.2	24	15.2	26	5	8.5	11.35	11.65	15	10
3/8" MPT	31.2	24	15.2	16	6				15	10
1/2" MPT	35.24	24	15.2	20.04	5.95	12.1			15	10
1/4" FPT	29.19	24	15.2	26	4.5	6.95	8.65		15	10
1/4" MPT	31.2	24	15.2	16	5				15	10
1/4" FPT	30	24			5				15	10
3/8" FPT	30	24			5.11				15	10