



HD-PE PIPE FITTING VALVE

HD-PE REDUCED 45° Y-TEE

(Fabricated)
with reduced branch
for butt welding
molded from PE100

手工對接異徑45°Y型三通
DFP TY7

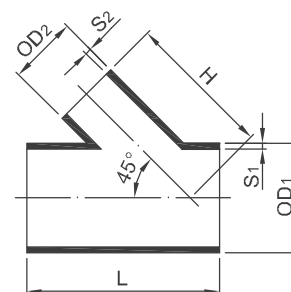

| OD ₁ /OD ₂ (mm) | H (mm) | L (mm) | SDR27.6 ISO S13.3 PN6 | | SDR17 ISO S8 PN10 | | SDR11 ISO S5 PN16 | |
|--|-----------|-----------|-----------------------------|-------------------------------------|-------------------------|-------------------------------------|-------------------------|-------------------------------------|
| | | | Code | S ₁ /S ₂ (mm) | Code | S ₁ /S ₂ (mm) | Code | S ₁ /S ₂ (mm) |
| 140-50 | 214 | 314 | - | - | 31-TY6-17-140050 | 8.3/3.0 | 31-TY6-11-140050 | 12.7/4.6 |
| 140-63 | 220 | 333 | 31-TY6-27-140063 | 5.1/2.3 | 31-TY6-17-140063 | 8.3/3.8 | 31-TY6-11-140063 | 12.7/5.8 |
| 140-75 | 226 | 350 | 31-TY6-27-140075 | 5.1/2.7 | 31-TY6-17-140075 | 8.3/4.5 | 31-TY6-11-140075 | 12.7/6.8 |
| 140-90 | 234 | 371 | 31-TY6-27-140090 | 5.1/3.3 | 31-TY6-17-140090 | 8.3/5.4 | 31-TY6-11-140090 | 12.7/8.2 |
| 140-110 | 244 | 399 | 31-TY6-27-140110 | 5.1/4.0 | 31-TY6-17-140110 | 8.3/6.6 | 31-TY6-11-140110 | 12.7/10.0 |
| 140-125 | 251 | 420 | 31-TY6-27-140125 | 5.1/4.6 | 31-TY6-17-140125 | 8.3/7.4 | 31-TY6-11-140125 | 12.7/11.4 |
| 160-63 | 245 | 360 | 31-TY6-27-160063 | 5.8/2.3 | 31-TY6-17-160063 | 9.5/3.8 | 31-TY6-11-160063 | 14.6/5.8 |
| 160-75 | 251 | 377 | 31-TY6-27-160075 | 5.8/2.7 | 31-TY6-17-160075 | 9.5/4.5 | 31-TY6-11-160075 | 14.6/6.8 |
| 160-125 | 276 | 447 | 31-TY6-27-160125 | 5.8/4.6 | 31-TY6-17-160125 | 9.5/7.4 | 31-TY6-11-160125 | 14.6/11.4 |
| 160-140 | 283 | 469 | 31-TY6-27-160140 | 5.8/5.1 | 31-TY6-17-160140 | 9.5/8.3 | 31-TY6-11-160140 | 14.6/12.7 |
| 180-75 | 265 | 377 | 31-TY6-27-180075 | 6.6/2.7 | 31-TY6-17-180075 | 10.7/4.5 | 31-TY6-11-180075 | 16.4/6.8 |
| 180-90 | 272 | 398 | 31-TY6-27-180090 | 6.6/3.3 | 31-TY6-17-180090 | 10.7/5.4 | 31-TY6-11-180090 | 16.4/8.2 |
| 180-110 | 300 | 426 | 31-TY6-27-180110 | 6.6/4.0 | 31-TY6-17-180110 | 10.7/6.6 | 31-TY6-11-180110 | 16.4/10.0 |
| 180-125 | 290 | 447 | 31-TY6-27-180125 | 6.6/4.6 | 31-TY6-17-180125 | 10.7/7.4 | 31-TY6-11-180125 | 16.4/11.4 |
| 180-140 | 297 | 469 | 31-TY6-27-180140 | 6.6/5.1 | 31-TY6-17-180140 | 10.7/8.3 | 31-TY6-11-180140 | 16.4/12.7 |
| 180-160 | 307 | 497 | 31-TY6-27-180160 | 6.6/5.8 | 31-TY6-17-180160 | 10.7/9.5 | 31-TY6-11-180160 | 16.4/14.6 |
| 200-90 | 296 | 425 | 31-TY6-27-200090 | 7.3/3.3 | 31-TY6-17-200090 | 11.9/5.4 | 31-TY6-11-200090 | 18.2/8.2 |
| 200-110 | 306 | 453 | 31-TY6-27-200110 | 7.3/4.0 | 31-TY6-17-200110 | 11.9/6.6 | 31-TY6-11-200110 | 18.2/10.0 |
| 200-125 | 338 | 475 | 31-TY6-27-200125 | 7.3/4.6 | 31-TY6-17-200125 | 11.9/7.4 | 31-TY6-11-200125 | 18.2/11.4 |
| 200-140 | 321 | 496 | 31-TY6-27-200140 | 7.3/5.1 | 31-TY6-17-200140 | 11.9/8.3 | 31-TY6-11-200140 | 18.2/12.7 |
| 200-160 | 331 | 524 | 31-TY6-27-200160 | 7.3/5.8 | 31-TY6-17-200160 | 11.9/9.5 | 31-TY6-11-200160 | 18.2/14.6 |
| 200-180 | 341 | 552 | 31-TY6-27-200180 | 7.3/6.6 | 31-TY6-17-200180 | 11.9/10.7 | 31-TY6-11-200180 | 18.2/16.4 |
| 225-110 | 334 | 482 | 31-TY6-27-225110 | 8.2/4.0 | 31-TY6-17-225110 | 13.4/6.6 | 31-TY6-11-225110 | 20.5/10.0 |
| 225-125 | 342 | 502 | 31-TY6-27-225125 | 8.2/4.6 | 31-TY6-17-225125 | 13.4/7.4 | 31-TY6-11-225125 | 20.5/11.4 |
| 225-140 | 349 | 523 | 31-TY6-27-225140 | 8.2/5.1 | 31-TY6-17-225140 | 13.4/8.3 | 31-TY6-11-225140 | 20.5/12.7 |
| 225-160 | 359 | 551 | 31-TY6-27-225160 | 8.2/5.8 | 31-TY6-17-225160 | 13.4/9.5 | 31-TY6-11-225160 | 20.5/14.6 |
| 225-180 | 369 | 579 | 31-TY6-27-225180 | 8.2/6.6 | 31-TY6-17-225180 | 13.4/10.7 | 31-TY6-11-225180 | 20.5/16.4 |
| 225-200 | 379 | 608 | 31-TY6-27-225200 | 8.2/7.3 | 31-TY6-17-225200 | 13.4/11.9 | 31-TY6-11-225200 | 20.5/18.2 |
| 250-125 | 374 | 542 | 31-TY6-27-250125 | 9.1/4.6 | 31-TY6-17-250125 | 14.8/7.4 | 31-TY6-11-250125 | 22.7/11.4 |
| 250-140 | 382 | 563 | 31-TY6-27-250140 | 9.1/5.1 | 31-TY6-17-250140 | 14.8/8.3 | 31-TY6-11-250140 | 22.7/12.7 |
| 250-160 | 392 | 592 | 31-TY6-27-250160 | 9.1/5.8 | 31-TY6-17-250160 | 14.8/9.5 | 31-TY6-11-250160 | 22.7/14.6 |
| 250-180 | 402 | 620 | 31-TY6-27-250180 | 9.1/6.6 | 31-TY6-17-250180 | 14.8/10.7 | 31-TY6-11-250180 | 22.7/16.4 |
| 250-200 | 412 | 648 | 31-TY6-27-250200 | 9.1/7.3 | 31-TY6-17-250200 | 14.8/11.9 | 31-TY6-11-250200 | 22.7/18.2 |
| 250-225 | 424 | 684 | 31-TY6-27-250225 | 9.1/8.2 | 31-TY6-17-250225 | 14.8/13.4 | 31-TY6-11-250225 | 22.7/20.5 |
| 280-140 | 418 | 632 | 31-TY6-27-280140 | 10.2/5.1 | 31-TY6-17-280140 | 16.6/8.3 | 31-TY6-11-280140 | 25.4/12.7 |
| 280-160 | 428 | 632 | 31-TY6-27-280160 | 10.2/5.8 | 31-TY6-17-280160 | 16.6/9.5 | 31-TY6-11-280160 | 25.4/14.6 |
| 280-180 | 439 | 661 | 31-TY6-27-280180 | 10.2/6.6 | 31-TY6-17-280180 | 16.6/10.7 | 31-TY6-11-280180 | 25.4/16.4 |
| 280-200 | 448 | 689 | 31-TY6-27-280200 | 10.2/7.3 | 31-TY6-17-280200 | 16.6/11.9 | 31-TY6-11-280200 | 25.4/18.2 |
| 280-225 | 460 | 724 | 31-TY6-27-280225 | 10.2/8.2 | 31-TY6-17-280225 | 16.6/13.4 | 31-TY6-11-280225 | 25.4/20.5 |
| 280-250 | 473 | 760 | 31-TY6-27-280250 | 10.2/9.1 | 31-TY6-17-280250 | 16.6/14.8 | 31-TY6-11-280250 | 25.4/22.7 |



HD-PE

PIPE FITTING VALVE

HD-PE REDUCED 45° Y-TEE

(Fabricated)
with reduced branch
for butt welding
molded from PE100

手工對接異徑45°Y型三通
DFP TY7

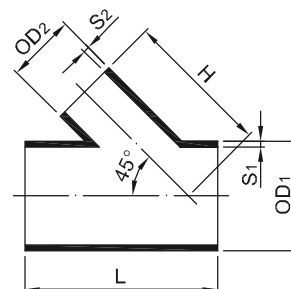

| OD ₁ /OD ₂ (mm) | H (mm) | L (mm) | SDR27.6 ISO S13.3 PN6 | | SDR17 ISO S8 PN10 | | SDR11 ISO S5 PN16 | |
|--|-----------|-----------|-----------------------------|--|-------------------------|--|-------------------------|--|
| | | | Code | S ₁ /S ₂ (mm) | Code | S ₁ /S ₂ (mm) | Code | S ₁ /S ₂ (mm) |
| 315-160 | 473 | 686 | 31-TY6-27-315160 | 11.4/5.8 | 31-TY6-17-315160 | 18.7/9.5 | 31-TY6-11-315160 | 28.6/14.6 |
| 315-180 | 483 | 715 | 31-TY6-27-315180 | 11.4/6.6 | 31-TY6-17-315180 | 18.7/10.7 | 31-TY6-11-315180 | 28.6/16.4 |
| 315-200 | 491 | 743 | 31-TY6-27-315200 | 11.4/7.3 | 31-TY6-17-315200 | 18.7/11.9 | 31-TY6-11-315200 | 28.6/18.2 |
| 315-225 | 505 | 772 | 31-TY6-27-315225 | 11.4/8.2 | 31-TY6-17-315225 | 18.7/13.4 | 31-TY6-11-315225 | 28.6/20.5 |
| 315-250 | 518 | 814 | 31-TY6-27-315250 | 11.4/9.1 | 31-TY6-17-315250 | 18.7/14.8 | 31-TY6-11-315250 | 28.6/22.7 |
| 355-280 | 576 | 897 | 31-TY6-27-355280 | 12.9/10.2 | 31-TY6-17-355280 | 21.1/16.6 | 31-TY6-11-355280 | 32.2/25.4 |
| 355-315 | 583 | 946 | 31-TY6-27-355315 | 12.9/11.4 | 31-TY6-17-355315 | 21.1/18.7 | 31-TY6-11-355315 | 32.2/28.6 |
| 400-200 | 593 | 851 | 31-TY6-27-400200 | 14.5/7.3 | 31-TY6-17-400200 | 23.7/11.9 | 31-TY6-11-400200 | 36.3/18.2 |
| 400-225 | 605 | 879 | 31-TY6-27-400225 | 14.5/8.2 | 31-TY6-17-400225 | 23.7/13.4 | 31-TY6-11-400225 | 36.3/20.5 |
| 400-250 | 611 | 922 | 31-TY6-27-400250 | 14.5/9.1 | 31-TY6-17-400250 | 23.7/14.8 | 31-TY6-11-400250 | 36.3/22.7 |
| 400-280 | 633 | 964 | 31-TY6-27-400280 | 14.5/10.2 | 31-TY6-17-400280 | 23.7/16.6 | 31-TY6-11-400280 | 36.3/25.4 |
| 400-315 | 650 | 1014 | 31-TY6-27-400315 | 14.5/11.4 | 31-TY6-17-400315 | 23.7/18.7 | 31-TY6-11-400315 | 36.3/28.6 |
| 400-355 | 670 | 1071 | 31-TY6-27-400355 | 14.5/12.9 | 31-TY6-17-400355 | 23.7/21.1 | 31-TY6-11-400355 | 36.3/32.2 |
| 450-225 | 666 | 954 | 31-TY6-27-450225 | 16.3/8.2 | 31-TY6-17-450225 | 26.7/13.4 | 31-TY6-11-450225 | 40.9/20.5 |
| 450-250 | 678 | 990 | 31-TY6-27-450250 | 16.3/9.1 | 31-TY6-17-450250 | 26.7/14.8 | 31-TY6-11-450250 | 40.9/22.7 |
| 450-280 | 693 | 1034 | 31-TY6-27-450280 | 16.3/10.2 | 31-TY6-17-450280 | 26.7/16.6 | 31-TY6-11-450280 | 40.9/25.4 |
| 450-315 | 711 | 1082 | 31-TY6-27-450315 | 16.3/11.4 | 31-TY6-17-450315 | 26.7/18.7 | 31-TY6-11-450315 | 40.9/28.6 |
| 450-355 | 731 | 1138 | 31-TY6-27-450355 | 16.3/12.9 | 31-TY6-17-450355 | 26.7/21.1 | 31-TY6-11-450355 | 40.9/32.2 |
| 450-400 | 753 | 1202 | 31-TY6-27-450400 | 16.3/14.5 | 31-TY6-17-450400 | 26.7/23.7 | 31-TY6-11-450400 | 40.9/36.3 |
| 500-250 | 739 | 1057 | 31-TY6-27-500250 | 18.1/9.1 | 31-TY6-17-500250 | 29.7/14.8 | 31-TY6-11-500250 | 45.4/22.7 |
| 500-280 | 754 | 1100 | 31-TY6-27-500280 | 18.1/10.2 | 31-TY6-17-500280 | 29.7/16.6 | 31-TY6-11-500280 | 45.4/25.4 |
| 500-315 | 775 | 1149 | 31-TY6-27-500315 | 18.1/11.4 | 31-TY6-17-500315 | 29.7/18.7 | 31-TY6-11-500315 | 45.4/28.6 |
| 500-355 | 791 | 1206 | 31-TY6-27-500355 | 18.1/12.9 | 31-TY6-17-500355 | 29.7/21.1 | 31-TY6-11-500355 | 45.4/32.2 |
| 500-400 | 814 | 1269 | 31-TY6-27-500400 | 18.1/14.5 | 31-TY6-17-500400 | 29.7/23.7 | 31-TY6-11-500400 | 45.4/36.3 |
| 500-450 | 839 | 1340 | 31-TY6-27-500450 | 18.1/16.3 | 31-TY6-17-500450 | 29.7/26.7 | 31-TY6-11-500450 | 45.4/40.9 |
| 560-280 | 826 | 1181 | 31-TY6-27-560280 | 20.3/10.2 | 31-TY6-17-560280 | 33.2/16.6 | 31-TY6-11-560280 | 50.8/25.4 |
| 560-315 | 843 | 1231 | 31-TY6-27-560315 | 20.3/11.4 | 31-TY6-17-560315 | 33.2/18.7 | 31-TY6-11-560315 | 50.8/28.6 |
| 560-355 | 871 | 1287 | 31-TY6-27-560355 | 20.3/12.9 | 31-TY6-17-560355 | 33.2/21.1 | 31-TY6-11-560355 | 50.8/32.2 |
| 560-400 | 886 | 1351 | 31-TY6-27-560400 | 20.3/14.5 | 31-TY6-17-560400 | 33.2/23.7 | 31-TY6-11-560400 | 50.8/36.3 |
| 560-450 | 911 | 1422 | 31-TY6-27-560450 | 20.3/16.3 | 31-TY6-17-560450 | 33.2/26.7 | 31-TY6-11-560450 | 50.8/40.9 |
| 560-500 | 936 | 1493 | 31-TY6-27-560500 | 20.3/18.1 | 31-TY6-17-560500 | 33.2/29.7 | 31-TY6-11-560500 | 50.8/45.4 |
| 630-315 | 928 | 1325 | 31-TY6-27-630315 | 22.8/11.4 | 31-TY6-17-630315 | 37.4/18.7 | 31-TY6-11-630315 | 57.2/28.6 |
| 630-355 | 948 | 1382 | 31-TY6-27-630355 | 22.8/12.9 | 31-TY6-17-630355 | 37.4/21.1 | 31-TY6-11-630355 | 57.2/32.2 |
| 630-400 | 970 | 1445 | 31-TY6-27-630400 | 22.8/14.5 | 31-TY6-17-630400 | 37.4/23.7 | 31-TY6-11-630400 | 57.2/36.3 |



HD-PE

PIPE FITTING VALVE

HD-PE REDUCED 45° Y-TEE

(Fabricated)
with reduced branch
for butt welding
molded from PE100

手工對接異徑45°Y型三通
DFP TY7

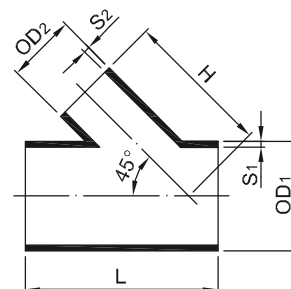

| OD ₁ /OD ₂ (mm) | H (mm) | L (mm) | SDR27.6 ISO S13.3 PN6 | | SDR17 ISO S8 PN10 | | SDR11 ISO S5 PN16 | |
|--|-----------|-----------|-----------------------------|--|-------------------------|--|-------------------------|--|
| | | | Code | S ₁ /S ₂ (mm) | Code | S ₁ /S ₂ (mm) | Code | S ₁ /S ₂ (mm) |
| 630-450 | 995 | 1516 | 31-TY6-27-630450 | 22.8/16.3 | 31-TY6-17-630450 | 37.4/26.7 | 31-TY6-11-630450 | 57.2/40.9 |
| 630-500 | 1020 | 1587 | 31-TY6-27-630500 | 22.8/18.1 | 31-TY6-17-630500 | 37.4/29.7 | 31-TY6-11-630500 | 57.2/45.4 |
| 630-560 | 1050 | 1672 | 31-TY6-27-630560 | 22.8/20.3 | 31-TY6-17-630560 | 37.4/33.2 | 31-TY6-11-630560 | 57.2/50.8 |
| 710-355 | 1045 | 1490 | 31-TY6-27-710355 | 25.7/12.9 | 31-TY6-17-710355 | 42.1/21.1 | 31-TY6-11-710355 | 64.5/32.2 |
| 710-400 | 1067 | 1554 | 31-TY6-27-710400 | 25.7/14.5 | 31-TY6-17-710400 | 42.1/23.7 | 31-TY6-11-710400 | 64.5/36.3 |
| 710-450 | 1091 | 1626 | 31-TY6-27-710450 | 25.7/16.3 | 31-TY6-17-710450 | 42.1/26.7 | 31-TY6-11-710450 | 64.5/40.9 |
| 710-500 | 1117 | 1695 | 31-TY6-27-710500 | 25.7/18.1 | 31-TY6-17-710500 | 42.1/29.7 | 31-TY6-11-710500 | 64.5/45.4 |
| 710-560 | 1147 | 1808 | 31-TY6-27-710560 | 25.7/20.3 | 31-TY6-17-710560 | 42.1/33.2 | 31-TY6-11-710560 | 64.5/50.8 |
| 710-630 | 1182 | 1879 | 31-TY6-27-710630 | 25.7/22.8 | 31-TY6-17-710305 | 42.1/37.4 | 31-TY6-11-710305 | 64.5/57.2 |
| 800-400 | 1176 | 1676 | 31-TY6-27-800400 | 29.0/14.5 | 31-TY6-17-800400 | 47.4/23.7 | 31-TY6-11-800400 | 72.8/36.3 |
| 800-450 | 1201 | 1746 | 31-TY6-27-800450 | 29.0/16.3 | 31-TY6-17-800450 | 47.4/26.7 | 31-TY6-11-800450 | 72.8/40.9 |
| 800-500 | 1226 | 1817 | 31-TY6-27-800500 | 29.0/18.1 | 31-TY6-17-800500 | 47.4/29.7 | 31-TY6-11-800500 | 72.8/45.4 |
| 800-560 | 1256 | 1902 | 31-TY6-27-800560 | 29.0/20.3 | 31-TY6-17-800560 | 47.4/33.2 | 31-TY6-11-800560 | 72.8/50.8 |
| 800-630 | 1291 | 2001 | 31-TY6-27-800630 | 29.0/22.8 | 31-TY6-17-800630 | 47.4/37.4 | 31-TY6-11-800630 | 72.8/57.2 |
| 800-710 | 1331 | 2114 | 31-TY6-27-800710 | 29.0/25.7 | 31-TY6-17-800710 | 47.4/42.1 | 31-TY6-11-800710 | 72.8/64.5 |
| 900-450 | 1321 | 1882 | 31-TY6-27-900450 | 32.6/16.3 | 31-TY6-17-900450 | 53.3/26.7 | 31-TY6-11-900450 | 81.8/40.9 |
| 900-500 | 1346 | 1952 | 31-TY6-27-900500 | 32.6/18.1 | 31-TY6-17-900500 | 53.3/29.7 | 31-TY6-11-900500 | 81.8/45.4 |
| 900-560 | 1374 | 2041 | 31-TY6-27-900560 | 32.6/20.3 | 31-TY6-17-900560 | 53.3/33.2 | 31-TY6-11-900560 | 81.8/50.8 |
| 900-630 | 1411 | 2138 | 31-TY6-27-900630 | 32.6/22.8 | 31-TY6-17-900630 | 53.3/37.4 | 31-TY6-11-900630 | 81.8/57.2 |
| 900-710 | 1451 | 2246 | 31-TY6-27-900710 | 32.6/25.7 | 31-TY6-17-900710 | 53.3/42.1 | 31-TY6-11-900710 | 81.8/64.5 |
| 900-800 | 1496 | 2378 | 31-TY6-27-900800 | 32.6/29.0 | 31-TY6-17-900800 | 53.3/47.4 | 31-TY6-11-900800 | 81.8/72.8 |
| 1000-500 | 1477 | 2115 | 31-TY6-27-100500 | 36.2/18.1 | 31-TY6-17-100500 | 59.3/29.7 | - | - |
| 1000-560 | 1507 | 2200 | 31-TY6-27-100560 | 36.2/20.3 | 31-TY6-17-100560 | 59.3/33.2 | - | - |
| 1000-630 | 1548 | 2294 | 31-TY6-27-100630 | 36.2/22.8 | 31-TY6-17-100630 | 59.3/37.4 | - | - |
| 1000-710 | 1580 | 2406 | 31-TY6-27-100710 | 36.2/25.7 | 31-TY6-17-100710 | 59.3/42.1 | - | - |
| 1000-800 | 1625 | 2537 | 31-TY6-27-100800 | 36.2/29.0 | 31-TY6-17-100800 | 59.3/47.4 | - | - |
| 1000-900 | 1675 | 2674 | 31-TY6-27-100900 | 36.2/32.6 | 31-TY6-17-100900 | 59.3/53.3 | - | - |
| 1200-560 | 1749 | 2470 | 31-TY6-27-120560 | 43.5/20.3 | 31-TY6-17-120560 | 67.9/33.2 | - | - |
| 1200-630 | 1784 | 2570 | 31-TY6-27-120630 | 43.5/22.8 | 31-TY6-17-120630 | 67.9/37.4 | - | - |
| 1200-710 | 1824 | 2682 | 31-TY6-27-120710 | 43.5/25.7 | 31-TY6-17-120710 | 67.9/42.1 | - | - |
| 1200-800 | 1869 | 2810 | 31-TY6-27-120800 | 43.5/29.0 | 31-TY6-17-120800 | 67.9/47.4 | - | - |
| 1200-900 | 1919 | 2951 | 31-TY6-27-120900 | 43.5/32.6 | 31-TY6-17-120900 | 67.9/53.3 | - | - |
| 1200-1000 | 1969 | 3093 | 31-TY6-27-120100 | 43.5/36.2 | 31-TY6-17-120100 | 67.9/59.3 | - | - |